

UTOPIA OF THE SEA



WINDOW TO THE WORLD
TRAVEL

CABIN AND SUITES LAYOUT



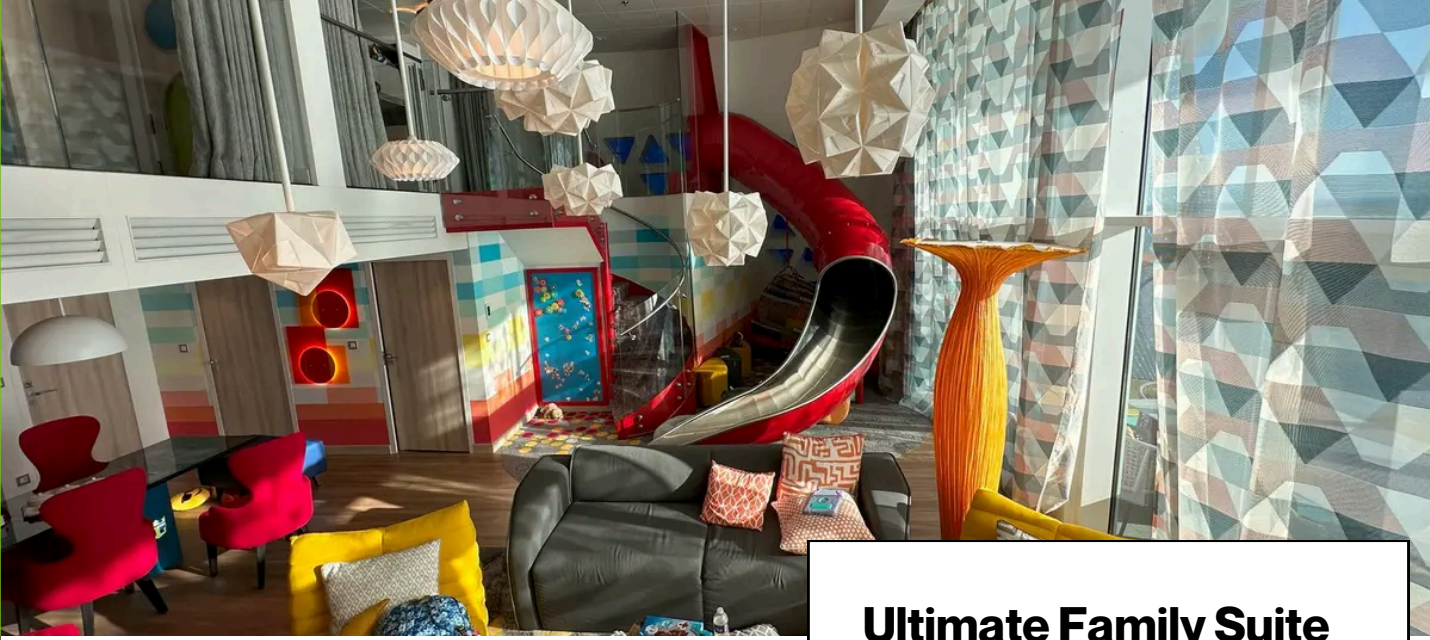

Ultimate Family Suite

Max passengers: 10

Staterooms number: 1

Cabin size: 2475 ft² / 230 m²

Balcony size: 540 ft² / 50 m²

Location: (2-level accommodation) midship-starboard on deck 18

Type: Duplex Apartment (US) Ultimate Family Suite



"Ultimate Family Suite" is a new cabin type (8-passenger, 2-bedroom loft suite sized 125 m² / 1350 ft²) featuring exclusive / in-cabin slide from the kids bedroom (upper level) down to the living room (lower level), floor-ceiling LEGO wall, air-hockey table, 2 hanging egg swing chairs, separate TV room (3D cinema, popcorn machine, media library, video gaming consoles with games), large wraparound balcony (sized 20 m² / 210 ft², fitted with bumper pool table, small climbing wall, full-size whirlpool).





Solarium Suite with Wraparound Windows

Max passengers: 4

Staterooms number: 2

Cabin size: 840 ft² / 78 m²

Balcony size: none

Location (on decks): forward on deck 14

Type (categories):

(SO) Solarium Suite with Wraparound Windows



This cabin type (suite without a balcony) was introduced on Allure OTS and Oasis OTS (as category UPS/Ultimate Panoramic Suite) following drydock refurbishments by RCI's "Royal Amplification" (fleetwide ship renovation program).

Utopia OTS' Solarium Suites (room numbers 14130/portside, and 14530/starboard) are adjacent to/above the Navigation Bridge (Wheelhouse on Deck 12) and feature a large bathroom (no whirlpool bath), separate living room (L-shaped 3-seater couch/double sofaed, 4-seat dining table, wardrobe, 2x contemporary armchairs and a glass table), separate bedroom (1 King-size double bed / convertible to 2x twin beds, mirrored vanity/writing desk with chair), walk-in closet. The bathroom is accessible only from the bedroom.

The lounge and the bedroom are both with wall-to-wall/floor-to-ceiling windows providing unobstructed top-deck views.





Royal Loft Suite

Max passengers: 6

Staterooms number: 1

Cabin size: 2605 ft² / 242 m²

Balcony size: 520 ft² / 48 m²

Location (on decks): (2-level accommodation)
midship-portside on deck 18

Type (categories): Duplex Apartment (RL) Royal Loft
Suite with Balcony Jacuzzi



The Royal Loft Suite as amenities features Master Bedroom (Royal King bed, Duxiana mattress, Frette linens, mirrored vanity with chair, closet), Master bathroom (bathtub, 2-sink vanity, bidet), 2nd bedroom (lower level / convertible twin beds, closet), dining room (dry bar), living room (double sofa bed, grand piano), 2nd bathroom (shower), large veranda (sitting area, bar area, dining area, whirlpool).

Additional (bonus) perks include luxury pillowtop mattress, premium-brand bath amenities, Coastal Kitchen (suite-only restaurant) all-day access, specialty (premium-brand) bottled water, Concierge Services (priority theater seats, reservations), Suite Sun Deck access, Suite Lounge access, Exclusive Suite Beach (private islands) access, priority embarkation / disembarkation, in-cabin dining, in-cabin welcome gifts, VOOM internet (complimentary), Spa Thermal Suite access (7-day pass).





Crown Loft Suite

Max passengers: 4

Staterooms number: 8

Cabin size: 670 ft² / 62 m²

Balcony size: 105 ft² / 10 m²

Location (on decks):

(2-level accommodation) midship on deck 18

Type (categories):

Duplex Apartment (L1) Crown Loft Suite with Balcony



Category "Crown Loft Suite Accessible" is larger both indoor (940 m² / 87 m²) and outdoor (155 ft² / 14 m² terrace).

The Crown Loft Suite as amenities features Master bedroom (on level 2 / Royal King bed, Duxiana mattress, Frette linens, mirrored vanity with chair, closet), Master bathroom (on level 2 / bathtub, 1-sink vanity), 2nd bedroom (lower level / convertible twin beds, closet), living room (double sofa bed, vanity desk with 2 chairs), 2nd bathroom (shower), private veranda (furnished with table and 2 chaise lounge chairs).

Additional (bonus) perks include luxury pillowtop mattress, premium-brand bath amenities, Coastal Kitchen (suite-only restaurant) all-day access, specialty (premium-brand) bottled water, Concierge Services (priority theater seats, reservations), Suite Sun Deck access, Suite Lounge access, Exclusive Suite Beach (private islands) access, priority embarkation / disembarkation, in-cabin dining, in-cabin welcome gifts, VOOM internet (complimentary), Spa Thermal Suite access (1-day pass).





UTOPIA of the SEAS

1-Bedroom Owners Suite

Max passengers: 4
 Staterooms number: 10
 Cabin size: 860 ft² / 80 m²
 Balcony size: 225 ft² / 21 m²
 Location (on decks): midship on deck 18
 Type (categories):
 (OS) Owners Suite with Balcony



Each of the Owners Suites as amenities features a separate bedroom (with 2 twin beds convertible to Royal King / double bed), full bathroom (bathtub, 2-sink vanity), living room (double sofa bed, 4-seat dining table, wardrobe), large terrace (furnished with 4-seat dining table, deck chairs, sun loungers).

Additional (bonus) perks include luxury pillowtop mattress, premium-brand bath amenities, Coastal Kitchen (suite-only restaurant) all-day access, specialty (premium-brand) bottled water, Concierge Services (priority theater seats, reservations), Suite Sun Deck access, Suite Lounge access, Exclusive Suite Beach (private islands) access, priority embarkation / disembarkation, in-cabin dining, in-cabin welcome gifts, VOOM internet (complimentary), Spa Thermal Suite access (1-day pass).





UTOPIA of the **SEAS**

2-Bedroom Aqua Theater Suite

Max passengers: 8

Staterooms number: 6

Cabin size: A1 (830 ft² / 77 m²), A2 (735-790 ft² / 68-71 m²)

Balcony size: A1 (650 ft² / 60 m²), A2 (505-575 ft² / 47-53 m²)

Location (on decks): aft on decks 8 (A1), 9-10 (A2)

Type (categories):

(A1-Spacious, A2-Large Balcony) Two-Bedroom Aqua Theater Suite with Wraparound Balcony

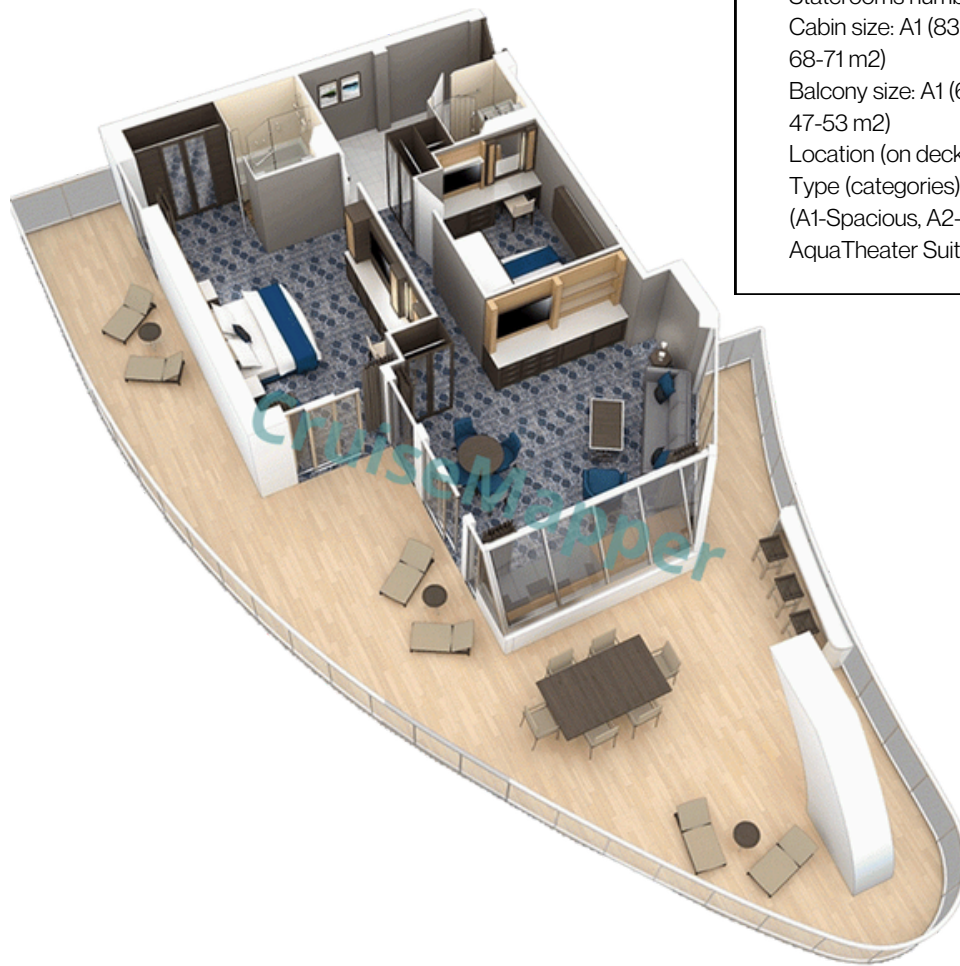

2-Bedroom AquaTheater Suites sizes vary according to deck location (in brackets ft² / m²) - deck 8 (830 / 77) and decks 9-10 (735-790 / 68-73)

2-Bedroom AquaTheater Suite balcony sizes also vary according to deck location (in brackets ft² / m²) - deck 8 (650 / 60) and decks 9-10 (505-575 / 47-53).

Each of the AquaTheater 2-Bedroom Suites as amenities features Master bedroom (Royal King bed, Duxiana mattress, mirrored vanity with chair, closet), 2nd bedroom (two twin beds convertible to Royal King double bed, 2 Pullman folding down beds, mirrored vanity with chair, closet), living area (double sofa bed), separate dining room, 2 bathrooms (Master has bathtub, 2-sink vanity), large veranda (sitting area, bar area, private dining area). Additional (bonus) perks include luxury pillowtop mattress, premium-brand bath amenities, Coastal Kitchen (suite-only restaurant) all-day access, specialty (premium-brand) bottled water, Concierge Services (priority theater seats, reservations), Suite Sun Deck access, Suite Lounge access, Exclusive Suite Beach (private islands) access, priority embarkation / disembarkation, in-cabin dining, in-cabin welcome gifts, VOOM internet (complimentary), Spa Thermal Suite access (1-day pass).





UTOPIA of the **SEAS**

1-Bedroom AquaTheater Suite

Max passengers: 4

Staterooms number: 6

Cabin size: 560-620 ft² / 52-58 m²

Balcony size: 450-475 ft² / 42-44 m²

Location (on decks): aft on decks 11, 12, 14

Type (categories):

(A3) One-Bedroom AquaTheater Suite with Wraparound Balcony

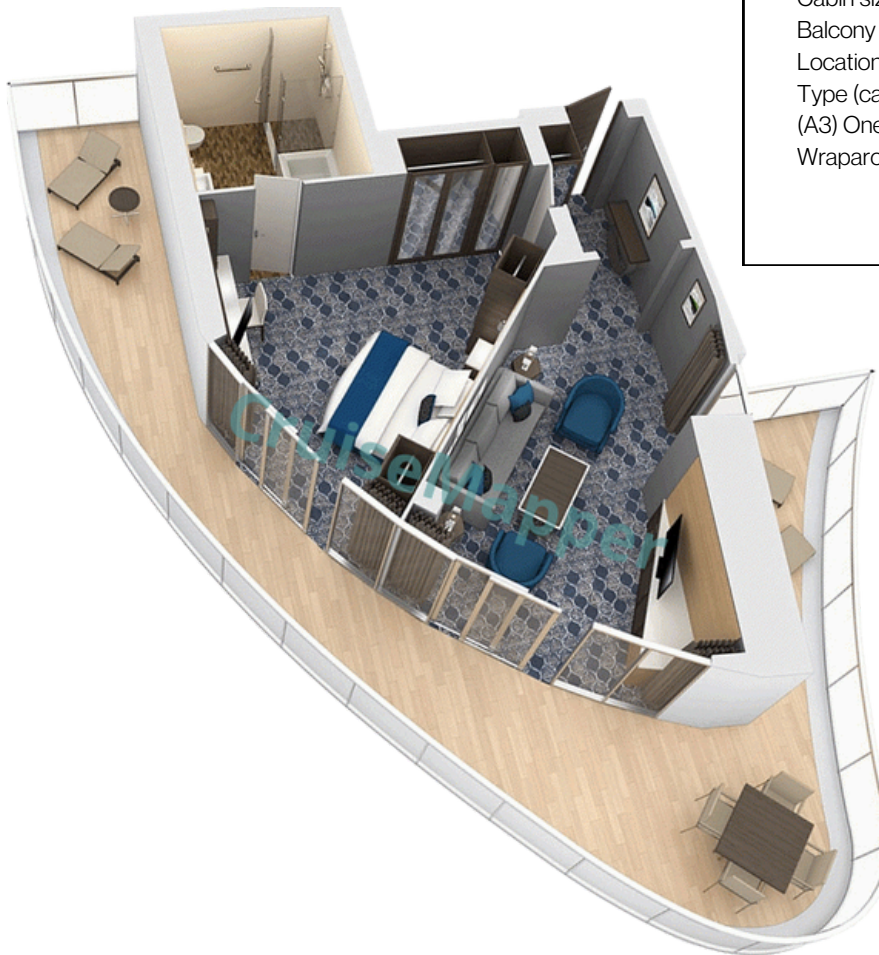

1-Bedroom AquaTheater Suites sizes vary (decks 11-12-14) vary between 560-620 ft² (52-58 m²).

1-Bedroom AquaTheater Suites balcony sizes vary (decks 11-12-14) vary between 450-475 ft² (42-44 m²).

Each of the AquaTheater 1-Bedroom Suites as amenities features bedroom (2 twin beds convertible to Royal King / double bed, Duxiana mattress, mirrored vanity with chair), large closet, living area (double sofa bed for 3rd-4th passenger), bathroom (bathtub, 1-sink vanity), large veranda (with seating area, private dining area).

Additional (bonus) perks include luxury pillowtop mattress, premium-brand bath amenities, Coastal Kitchen (suite-only restaurant) all-day access, specialty (premium-brand) bottled water, Concierge Services (priority theater seats, reservations), Suite Sun Deck access, Suite Lounge access, Exclusive Suite Beach (private islands) access, priority embarkation / disembarkation, in-cabin dining, in-cabin welcome gifts, VOOM internet (complimentary), Spa Thermal Suite access (1-day pass).





UTOPIA of the SEAS



1-Bedroom Grand Suite

Max passengers: 8

Staterooms number: 6

Cabin size: A1 (830 ft² / 77 m²), A2 (735-790 ft² / 68-71 m²)

Balcony size: A1 (650 ft² / 60 m²), A2 (505-575 ft² / 47-53 m²)

Location (on decks): aft on decks 8 (A1), 9-10 (A2)

Type (categories):

(A1-Spacious, A2-Large Balcony) Two-Bedroom

AquaTheater Suite with Wraparound Balcony



The 1-Bedroom Accessible Grand Suite is same-sized.

Each of the One-Bedroom Grand Suites as amenities features a separate bedroom (with 2 twin beds convertible to Royal King / double bed), full bathroom (bathtub, 2-sink vanity), living room (double sofa bed for 3rd/4th person), large balcony (with deckchairs and a dining table). The terrace is accessed from both the bedroom and the living room. Additional (bonus) perks include luxury pillowtop mattress, premium-brand bath amenities, Coastal Kitchen (suite-only restaurant) all-day access, specialty (premium-brand) bottled water, Concierge Services (priority theater seats, reservations), Suite Sun Deck access, Suite Lounge access, Exclusive Suite Beach (private islands) access, priority embarkation / disembarkation, in-cabin dining, in-cabin welcome gifts, VOOM internet (complimentary), Spa Thermal Suite access (1-day pass).





UTOPIA of the SEAS

Junior Suite

Max passengers: 4 (J3-J4), 5 (JY)

Staterooms number: 115

Cabin size:

J3-J4 (290 ft² / 27 m²), JY (300 ft² / 28 m²)

Balcony size:

J3-J4 (80 ft² / 8 m²), JY (120 ft² / 11 m²)

Location (on decks):

midship on decks 6 (JY), 7, 8, 9, 10, 11, 12, 14

Type (categories):

(J3-Quad, J4-Double, JY-Sky) Junior Suite with Balcony



Category "Junior Suite Accessible" cabins are larger-sized, with interior 390 ft² (36 m²) and balcony 110 ft² (10 m²).

Each of the Junior Suites as amenities features 2 twin beds (convertible to Royal King / double), full bathroom (bathtub), sitting area (double sofa bed for 3rd/4th person), private bathroom, private balcony. Additional (bonus) perks include luxury pillowtop mattress, premium-brand bath amenities, Coastal Kitchen (suite-only restaurant) dinner access, specialty (premium-brand) bottled water.

Sky Junior Suites (cat JY, 8x staterooms midship on Deck 6/within the Suite Neighborhood) receive expanded benefits (Sky Class) while standard Junior Suites (cat J3-J4) are Sea Class. Sky Junior Suite's perks include access to Coastal Kitchen (Suite-only complimentary restaurant/dining room).





UTOPIA of the SEAS

Ultra-Spacious Family Balcony Cabin

Max passengers: 6

Staterooms number: 5

Cabin size: 305-405 ft² / 28-38 m²

Balcony size: 80-110 ft² / 8-10 m²

Location (on decks):

forward-portside on deck 11

Type (categories):

(1A "Ultra Spacious") Family Balcony Stateroom



Category "Family Balcony Accessible" is larger (405 ft² / 38 m²) plus the balcony (110 ft² / 10 m²). Each of the "Ultra Spacious" family balcony cabins as amenities features 2 twin beds (convertible to Royal King / double bed), 2 Pullman (folding down) beds, sitting area (double sofa bed), private bathroom, private veranda.





UTOPIA *of the* **SEAS**

Spacious Balcony Cabin

Max passengers: 4

Staterooms number: 1436

Cabin size: 180-190 ft² / 17-18 m²

Balcony size: 55-80 ft² / 5-7 m²

Location (on decks): 6, 7, 8, 9, 10, 11, 12, 14

Type (categories):

(CB-Connecting, 4D-2D-2C-Double, 3D-1D-1C-Quad) Spacious Balcony staterooms

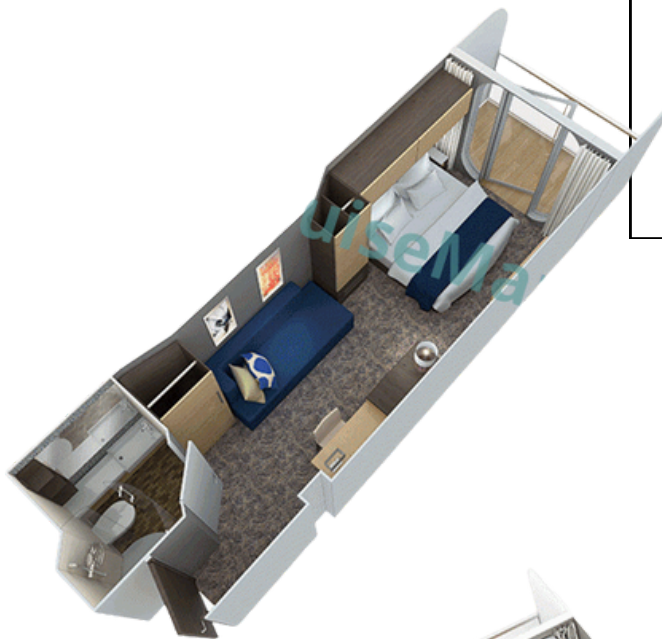

Categories 1C-2C "Ocean View with Large Balcony" cabins have larger verandas (80 ft² / 7 m²). Each of the balcony cabins as amenities features Royal King (double) bed, private veranda, sitting area (sofa or double sofa bed for 3rd/4th person), private bathroom.





2-Bedroom Family Oceanview Cabin

Max passengers: 6

Staterooms number: 8

Cabin size: 285-365 ft² / 27-34 m²

Balcony size: none

Location (on decks): forward on deck 11

Type (categories):

(1K) Ultra-Spacious Oceanview / Bow-Facing Family Oceanview Cabin



Category "Ultra-Spacious Oceanview" is a family-type stateroom (bow-facing) with Master bedroom (2 single twin beds convertible to a Queen-size double bed), second bedroom (2 Pullman beds/upper and lower bunks), a double sofa bed (in the living room), 1 bathroom (WC-shower), 2 round windows (non-opening).

Staterooms 11100 and 11500 are with obstructed views.

Oceanview Cabin





UTOPIA of the **SEAS**



Oceanview Cabin

Max passengers: 4

Staterooms number: 150

Cabin size: 175-185 ft² / 16-17 m²

Balcony size: none

Location (on decks): 3, 7, 8, 9, 10, 11

Type (categories):

(2N-4N-Double, 1N-3N-Quad) Oceanview / Outside cabins



Category "Ultra-Spacious Oceanview" is a family-type stateroom (bow-facing) with Master bedroom (2 single twin beds convertible to a Queen-size double bed), second bedroom (2 Pullman beds/upper and lower bunks), a double sofa bed (in the living room), 1 bathroom (WC-shower), 2 round windows (non-opening).

Staterooms 11100 and 11500 are with obstructed views.





UTOPIA of the SEAS

Boardwalk and Central Park Balcony Cabins

Max passengers: 4

Stateroom number: 477

Cabin size: 190 ft² / 18 m²

Balcony size: 50 ft² / 5 m²

Location (on decks): 8, 9, 10, 11, 12, 14

Type (categories):

(2I-Double, 1I-Quad) Boardwalk View Balcony, (2J-Double, 1J-Quad) Central Park Balcony Staterooms

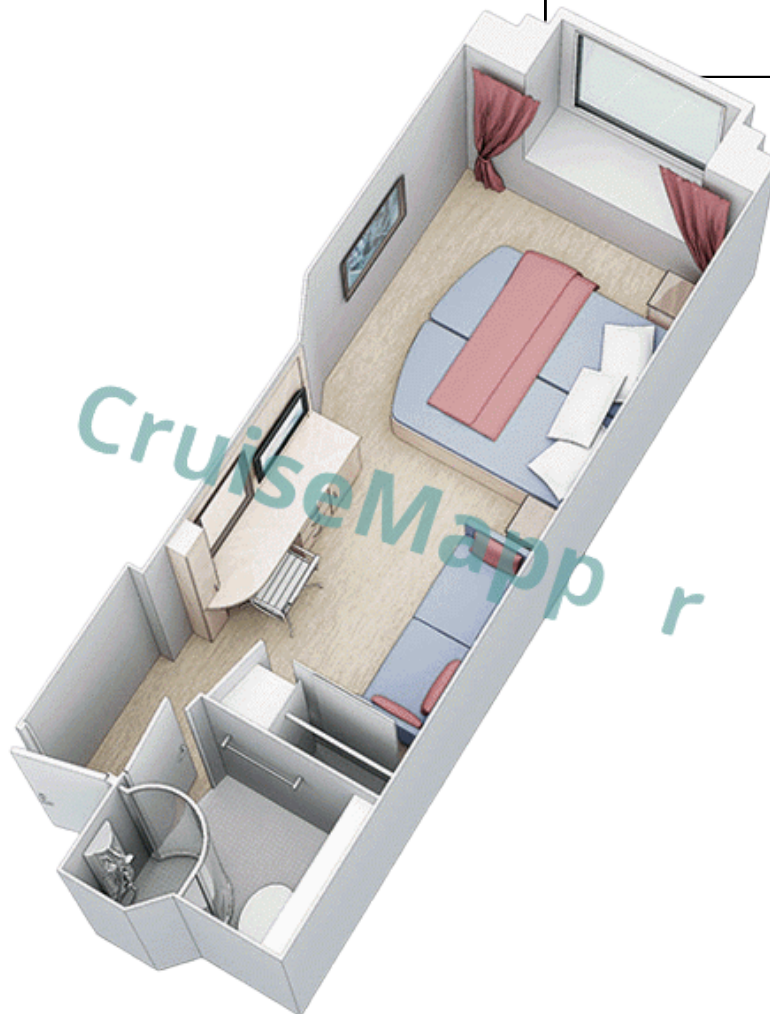

CruiseMapper

Categories "Boardwalk Balcony Accessible" and "Central Park Balcony Accessible" cabins are large-sized (280 ft² / 26 m²) and with bigger balconies (75 ft² / 7 m²).

The following numbers "Boardwalk View Balcony" staterooms are with obstructed views: 8329, 9329, 9729, 10329, 10729, 11327, 11329, 11727, 11729, 12329, 12729, 14315, 14319, 14321, 14323, 14325, 14715, 14717, 14719, 14721, 14723, 14725.





Promenade View Interior Cabin

Max passengers: 4

Staterooms number: 26

Cabin size: 180 ft² / 17 m²

Balcony size: none

Location (on decks): 7

Type (categories):

(2T) Atrium Promenade View Interior / Inside cabins

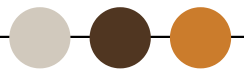

Category 2T-Promenade cabins as amenities offer 2 twin beds (convertible to Queen-size double bed), sitting area (double sofa bed), bay window views (bow window overlooking the Royal Promenade / ship's interior).





Spacious Interior Family Cabin

Max passengers: 6

Staterooms number: 4

Cabin size: 270 ft² / 25 m²

Balcony size: none

Location (on decks): forward on deck 11

Type (categories):

(1R) Spacious Interior / Family Inside cabins



Category "Family Interior" cabins have each 2 lower single beds (twins convertible to a double bed/Queen-size), separate bedroom (with 2 Pullman beds/lower-upper bunk beds), 1 double sofa bed.



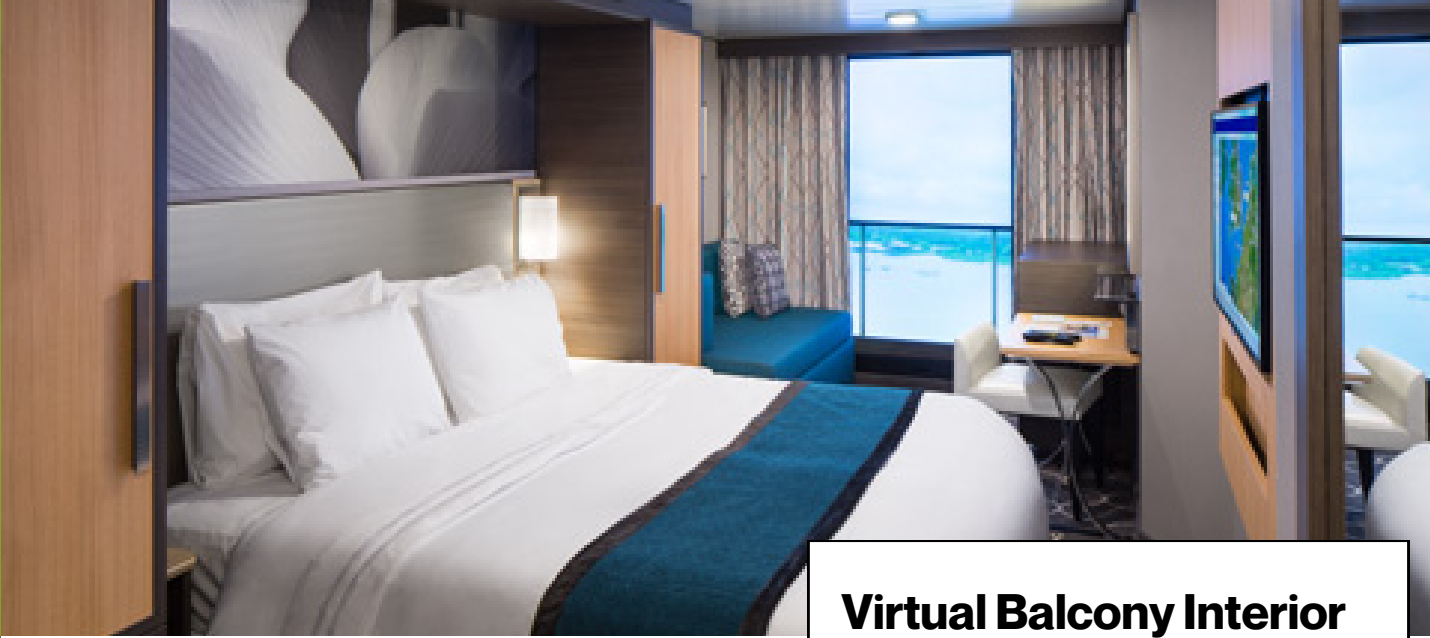

Virtual Balcony Interior Cabin

Max passengers: 2-4

Staterooms number: 477

Cabin size: 150-170 ft² / 14-16 m²

Balcony size: none

Location (on decks): 3, 6, 7, 8, 9, 10, 11, 12, 14

Type (categories):

(CI-Connecting, 2V-4V-Double, 1V-3V-Quad, 4U-Virtual Balcony) Interior / Inside staterooms



CruiseMatters

Category "Interior Accessible" cabins are larger-sized (260 ft² / 24 m²) and with 2 twin beds (convertible to King-size double bed) plus 1 double sofa bed. The other Interior quad cabins are fitted with 2 twin beds (convertible) plus 2 Pullman beds (foldable).

Connecting Interior are double cabins.

Interior cabins located aft on decks 7 through 14 are smaller-sized (150 ft² / 14 m²).





Studio Single Cabin

Max passengers: 2

Staterooms number: 15 (3x Interior plus 12x Oceanview)

Cabin size: Interior (105 ft² / 10 m²), Oceanview (95 ft² / 9 m²)

Balcony size: none

Location (on decks): 4

Type (categories):

(2O) Studio Oceanview, (2W) Studio Interior / single-occupancy cabins



Single Cabin's amenities include 1 double bed, full bathroom (WC, shower, single-sink vanity, window), closet, radio, phone, hairdryer.

These double cabins can be booked with single-occupancy rates (a single supplement is not required).

Studio Oceanview rooms are numbers 4662, 4664, 4666, 4668, 4670, 4672, 4674, 4676, 4678, 4680, 4682.

Studio Interior rooms are numbers 4660, 4684, 4686.

